

103
4413

Mercedes Vito/Viano; Md. 2011*

EU-pedestrian protection bar 60 high with cross pipe 42

EU-Personenschutzbügel 60 hoch mit Querrohr 42

Barre de protection des piétons CE 60 mm haut avec tube transversal 42

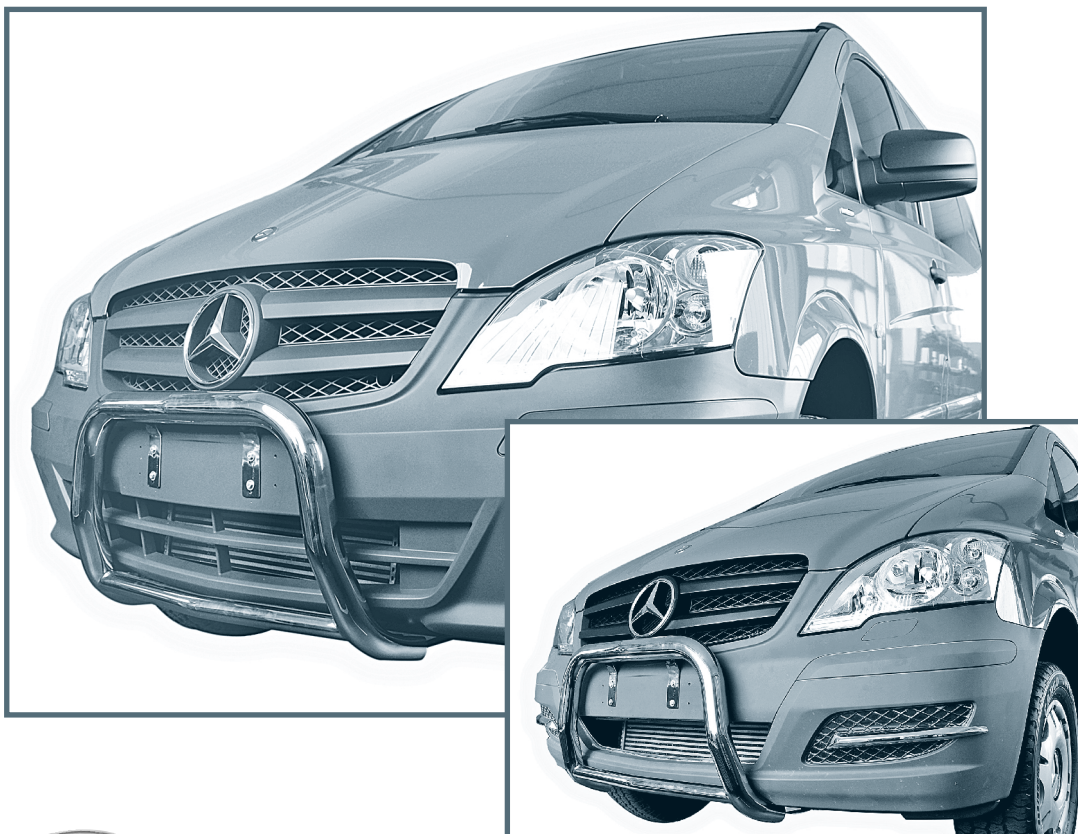

ASSEMBLY INSTRUCTION

Montageanleitung • Instructions de montage



45 Minuten

- * nicht kompatibel mit Park DistanceControl (PDC)
- * not compatible with Park DistanceControl (PDC)
- * pas compatible avec Park DistanceControl (PDC)

Product-No.:

103 4413 Stainless Steel

103 5413 black Steel

103 9413 Assembly-kit

Revision 3: 02.02.2023



103 4413

Mercedes Vito/Viano; Md. 2011*

EU-pedestrian protection bar 60 high with cross pipe 42

EU-Personenschutzbügel 60 hoch mit Querrohr 42

Barre de protection des piétons CE 60 mm haut avec tube transversal 42

Required tools / Benötigte Werkzeuge / Outillage requis

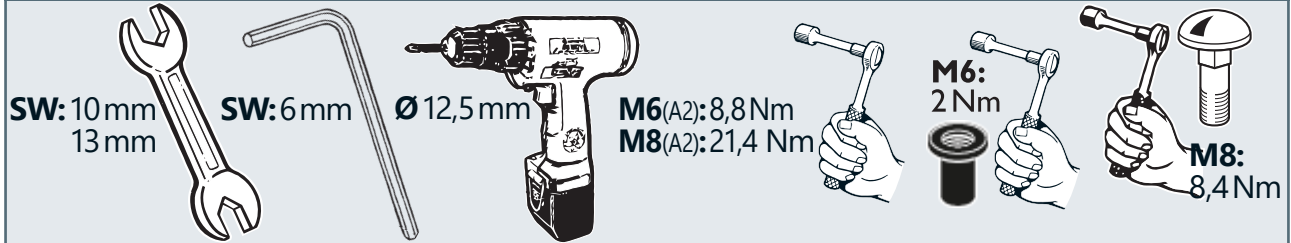

Parts list / Teilleiste / Lista de accesorios

1 1034413.1 / 1035413.1

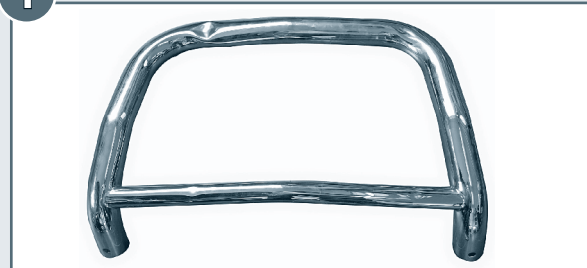

1039413

2 1035228

2x

3 1035224R / 1035225L



4 1035232.1R /
1035232.2L



5 1035234.1R /
1035234.2L



a		M6x25; DIN 933 A2	4x
b		M8x20; DIN 933 A2	2x
c		M8x20; DIN 912 A2	2x
d		M8x20; DIN 603 A2	2x
e		ø6,4; DIN 9021 A2	4x
f		ø8,4 DIN 9021 A2	6x
g		ø8; 127 A2	4x
h		M8; 934 A2	2x
j		SW 13mm	2x
k		M6; GETO-WELL	4x

Product-No.:

103 4413 Stainless Steel

103 5413 black Steel

103 9413 Assembly-kit

Revision 3: 02.02.2023

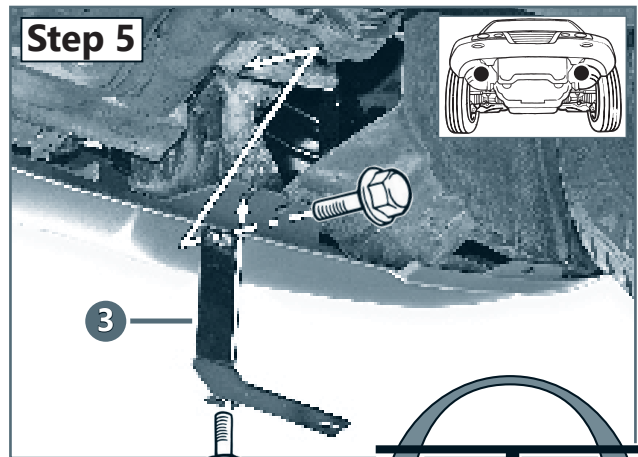
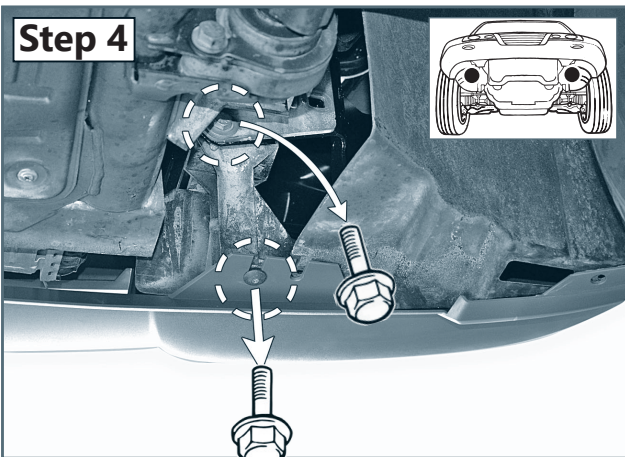
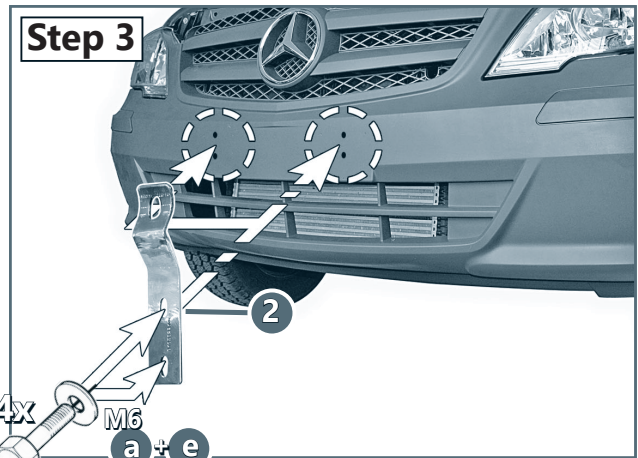
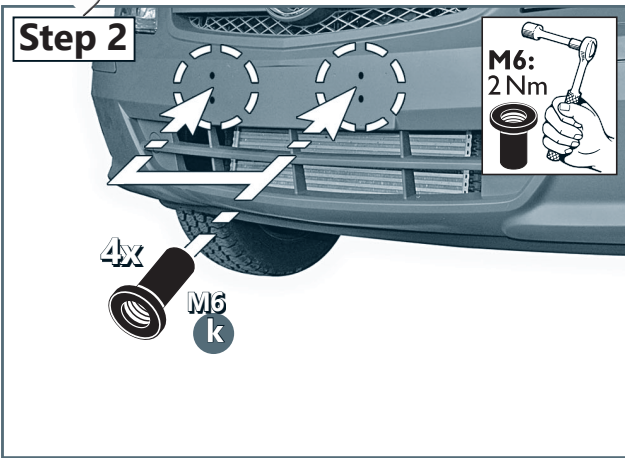
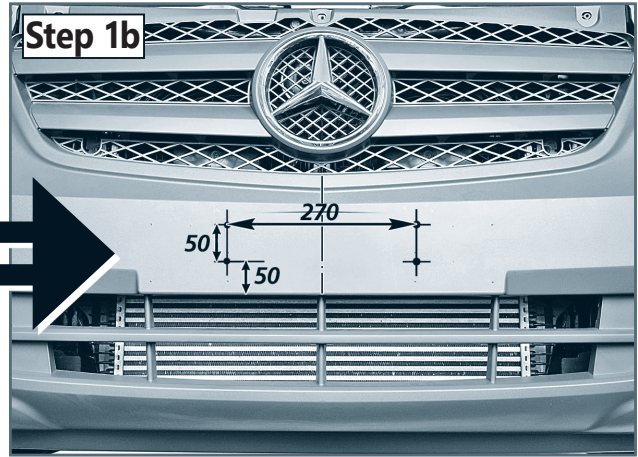
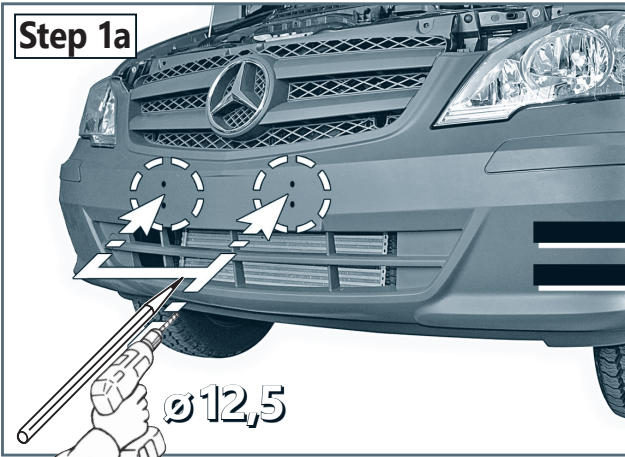

product-number:
103 4413 Stainless Steel

Revision 3: 02.02.2023

